

Jinan MORN Technology Co., Ltd.

MORN GROUP LIMITED

Tel: +86 531 8869 2337

Web: [www.morntech.com](http://www.morntech.com)

Address: 13F, Building 5, Qisheng Mansion, Xinluo Street,  
High-Tech Zone, Jinan, China, 250101

LASER SOLUTION

**MORN LASER** 

JINAN MORN TECHNOLOGY CO., LTD.

MORN GROUP LIMITED



# > CONTENTS

01 Company Profile-----p1-p1

02 International Representation, Agent and Distributor Opportunities-p2-p2

03 Research and Development Philosophy-----p3-p4

04 Our Accomplishments & Industry Recognition To Date-----p5-p6

05 Fiber Laser Cutting Equipment-----p7-p20

·Enclosed Fiber Laser Cutting Machine-----p7-p8

·Exchange Table Fiber Laser Cutting Machine-----p9-p10

·Metal Sheet Fiber Laser Cutting Machine-----p11-p12

·Sheet and Tube Fiber Laser Cutting Machine-----p13-p14

·Tube Fiber Laser Cutting Machine-----p15-p16

·Economical Sheet Fiber Laser Cutting Machine-----p17-p18

·Mini Fiber Laser Cutting Machine-----p19-p20

06 Laser Welding Machine-----p21-p26

·Handheld Laser Welding Machine-----p21-p22

·Automatic Laser Welding Machine-----p23-p24

·Handheld YAG Laser Welding Machine-----p25-p26

07 Laser Cleaning Machine-----p27-p28

·Laser Cleaning Machine-----p27-p28

08 Laser Marking Machine-----p29-p40

·Desktop Fiber Laser Marking Machine-----p29-p30

·Mini Fiber Laser Marking Machine-----p31-p32

·All Sealed Fiber Laser Marking Machine-----p33-p34

·Portable Fiber Laser Marking Machine-----p35-p36

·Handheld Fiber Laser Marking Machine-----p37-p38

·Customized Types-----p39-p40

09 CO2 Engraving And Cutting Machine-----p41-p48

·Big Size CO2 Laser Cutting Machine-----p41-p42

·CO2 Laser Engraving and Cutting Machine-----p43-p44

·Dual Head CO2 Laser Cutting Machine-----p45-p46

·Fabric CO2 Laser Cutting Machine-----p47-p48

10 Global Service-----p49-p52

·Global Service-----p49-p50

·Exhibition Pictures-----p51-p52

·On-site Installation-----p51-p52

·Client Feedback -----p51-p52



## [ COMPANY PROFILE ]

Jinan MORN Technology Co., Ltd. was founded by Mr. Li, Ms. Dong and their supporters in 2008. They have long harbored the dream of consistently providing quality equipment to the global market. MORN LASER is the trademark registered by the Laser Business Division of MORN GROUP.

Headquartered in Jinan, our company is committed to the ongoing innovation, high quality and consistent manufacturing while providing and maintaining exemplary after sales services to support an ever growing portfolio of world class Industrial Laser products and related solutions. These products are used extensively throughout the industry for cutting, welding, engraving, cleaning and marking of materials with unrivaled laser precision. The company is also perfectly positioned to provide very specific and proprietary laser solutions wherever these might be needed.

All of our products are certified CE compliant and have also obtained FDA approval.

Since inception the company has been geared towards the international market and to date we have successfully applied for brand and patent protection across 55 countries. We have successfully established warehouse operations and regional after sales service centers in America, Britain, Philippines and Romania.

Our core philosophy is to build value with our clients, we do this by understanding and analyzing their specific challenges and are thereby able to provide a tailored solution to match, in so doing we are able to directly contribute to the success of our clients business.



## [ INTERNATIONAL REPRESENTATION AGENT AND DISTRIBUTOR OPPORTUNITIES ]

### Representative Requirements

- Proven sales performance within 1 year
- Promotional equipment showroom
- Professional services team

### Manufacturer support provided

- Very competitive rates & regional trade protection
- Generous incentives & complimenting finance terms
- Significant promotional resources offered
- Priority Service response and Professional training

**2008**

Established in 2008

**155**

Exporting to 155 countries

**60,000+**

We currently serve over 60,000 satisfied customers worldwide



# RESEARCH AND DEVELOPMENT PHILOSOPHY

MORN attaches great importance to the transformation that takes place in the scientific and technological fields, with ever progressive advancements and breakthroughs that occur in these fields new opportunities arise for the enhancement and improvement of our products. For this reason, MORN has established a long-standing cooperation with the National Engineering Research Center for Laser Processing at Huazhong University of Science and Technology. Our co-developed multi-functional laser cutting equipment and multi-functional laser welding equipment represent the advancement in this field made both domestically and abroad. These advancements have successfully been applied across many industries including Mechanical Engineering, Electronics, Metallurgy, Energy and Petrochemicals to name a few examples.

Our fiber laser cutting equipment has proven to be extremely reliable and recognized for the high productivity, stability and consistency that are achievable in sheet and tube processing applications. The fiber welding system serves a wider scope of applications depending on whether these are integrated with an auto welding or handheld gun. The wobble laser gun widens the weld seam in a uniform and controlled manner while simultaneously reducing the required laser power. The laser is designed in such a manner that it will not emit unless the laser welding gun comes into contact with the workpiece to which the ground wire is connected following the practices inherent to conventional welding. Both innovations have received significant recognition from users across the industry.

We now hold 36 patents and 13 patents are currently pending. With the advent of the 4th Industrial revolution, MORN will provide more and more industry-leading intelligent solutions.



## Research and Development

Continue to increase R & D funding, develop advanced products that meet the needs of the laser industry.

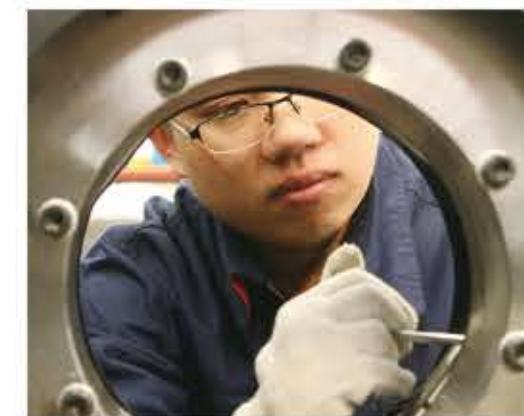

## Fine Manufacturing

Be attentive to details and keep improving products, constantly strive for excellence.



## Technology Upgrading

Utilize the latest advances in laser technology, keep upgrading technology to sharpen the edge of MORN products.



## Technical Exchange

Keep paces with international top-notch brand laser manufacturers, organize technical exchange meetings and learn advanced production experience.



## Technical Service Team

Develop multi-level tech service system, improve the service process, reduce the response time, and provide the professional and efficient solutions.



## Skilled Worker Training

Pay attention to workers' technical skill training and organize regular skill assessments, only those who pass the assessments can go on post.



05 MORN LASER  
www.mornitech.com





# ALL COVER FIBER LASER CUTTING MACHINE

MORN's fully enclosed laser cutting machine is designed for metal cutting applications within a demanding industrial production environment.

The machine is fully contained by the robust enclosure while the exhaust system ensures safe and pollution free operations.

The glass viewing window is fitted with a special laser protection lens that ensures there is no risk of harm to human eyes. A tube cutting attachment can be fitted for multi-functional processing.

## Features

- Fully enclosed with powerful exhaust system to protect the operators from noise, smoke, sparks and slag splashes;
- Auto shuttle pallets cut feeding idle time and improve your processing efficiency;
- Automated lens height adjustment ensures burr-free cuts for all material thickness.

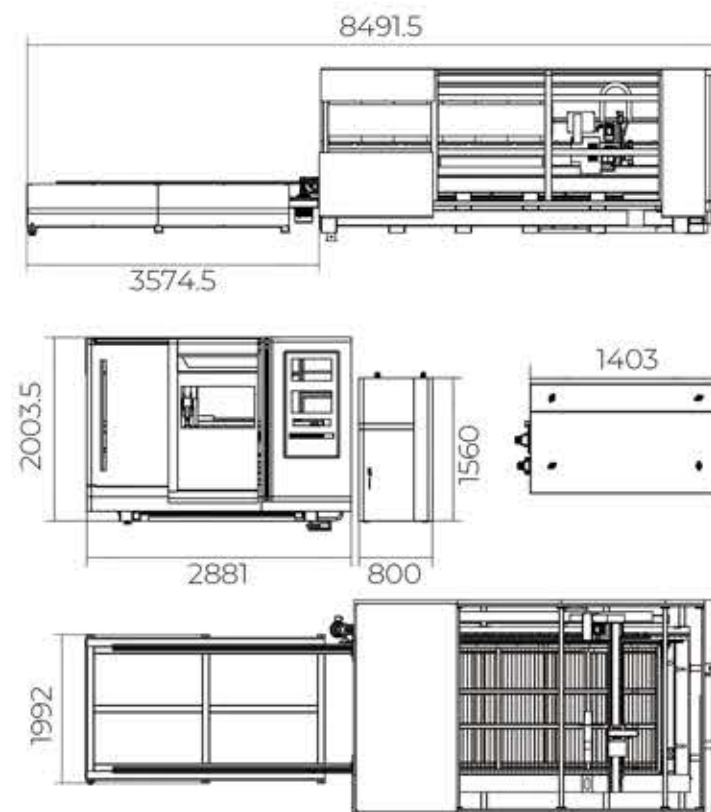

Brass 1-40mm



CS 1-45mm



SS 1-50mm



Aluminum 1-40mm

Equipment model

Laser type

Laser wavelength

Rated output power

Effective cutting range

Table

Workbench axial positioning accuracy

Workbench repositioning accuracy

Cutting speed

Max no-load speed

Cutting head

Transmit way

Reducer

Drive system

Water chiller

Software

Electrical requirements

MT-L1530FH / MT-L2040FH / MT-L2560FH

Fiber laser generator

1080±5nm

1000W-12000W optional

1500\*3000mm/ 2000\*4000mm / 2500\*6000mm optioal

Two, automatic exchange

≤±0.03mm

≤±0.02mm

Dependent on material and thickness

120m/min

Switzerland Raytools laser head

Dual Rack & Pinion type

Japan Shimpo

Japan Yaskawa servo motor and driver

Industrial water chiller

Cypcut control software

3 Phases 380V±10% 50HZ/60HZ or 3 Phases or single Phase 220V±10% optional



# EXCHANGE TABLE FIBER LASER CUTTING MACHINE

MORN's exchange table fiber laser type is developed to improve the production turn-around efficiency. With double auto-switched pallets, cutting and loading/unloading can be performed concurrently. The equipment is extremely cost-effective. It is preferred by enterprises with large processing volumes where equipment has to work on an ongoing basis.

### Features

- Auto chain-type parallel pallets system, fast exchange speed, convenient loading;
- High productivity, high precision cuts, low operating cost;
- Smooth and accurate processing of complex graphics;
- Narrow kerf, small heat-affected zone and nearly no thermal deformation.

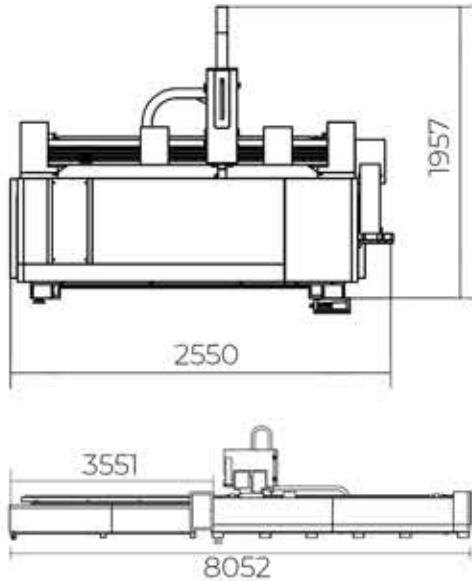

SS 1-50mm



Aluminum 1-40mm



CS 1-45mm



SS 1-50mm

Equipment model

Fiber laser source

Effective cutting range

Tables

Tables exchanging time

Laser wavelength

Laser source

Laser cutting head

Control system

Reducer

Drive system

Pneumatic elements

Electrical parts

Guide rail

Cooling system

Oiling system

Electrical requirement

MT-L1530FE / MT-L2040FE / MT-L2560FE

500W-12000W optional

1500\*3000mm / 2000\*4000mm / 2500\*6000mm optional

Two, automatic exchange

10s

1080±5nm

Raycus / IPG / Photonics optional

Raytools

Cypcut

Japan Shimpo

Japan YASKAWA servo driver and motors

Japan SMC

France Schneider

Taiwan square guide rail

Constant temperature controller water chiller

Automatic oiling system

3 Phases 380V±10% 50HZ/60HZ or 3 Phases or single Phase 220V±10% optional



# METAL SHEET FIBER LASER CUTTING MACHINE

MORN's metal sheet fiber laser stands out on precise cutting of complex, intricate contours. Perfect industrial design is more in line with man-machine engineering.

It works great with CS, SS, MS, aluminum, brass, copper, bronze, gold, silver, titanium alloy, galvanized plates, etc.

The machine is affordable and tailored for sheet metal processing enterprise.

## Features

- Stand-alone electrical cabinet, wireless remote control.
- High configuration, stable performance, long service life.
- High quality finishing, no need for any post-processing.
- LED light strips, stylish design.

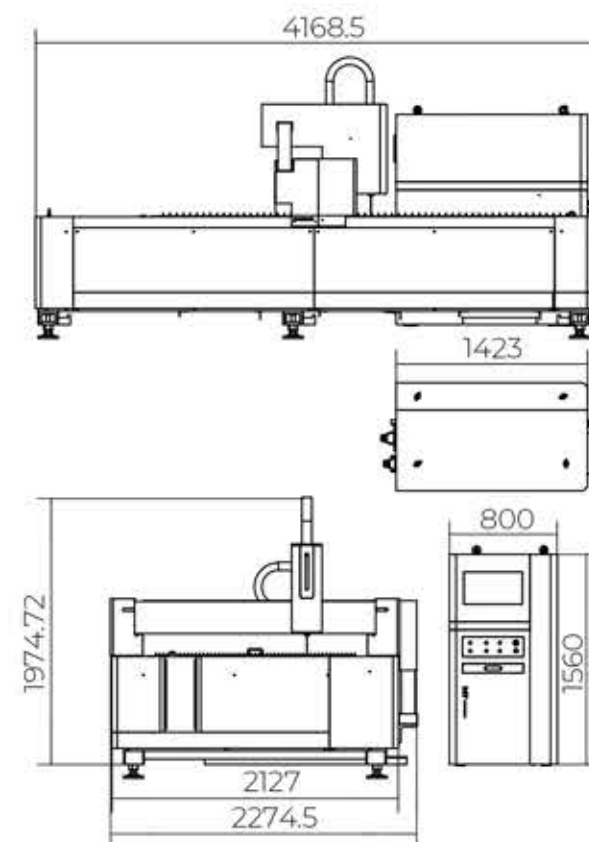

Aluminum 1-40mm



SS 1-50mm



Brass 1-40mm



CS 1-45mm

Equipment model	MT-L1530F / MT-L2040F / MT-L2560F
Laser type	Fiber laser
Rated output power	500W-12000W optional
Effective cutting range	1500*3000mm / 2000*4000mm / 2500*6000mm optional
Reposition accuracy	0.02mm
Laser wavelength	1080±5nm
Laser source	Raycus
Laser cutting head	Raytools
Control system	Cypcut
Reducer	Japan Shimpo
Drive system	Japan YASKAWA servo driver and motors
Pneumatic elements	Japan SMC
Electrical parts	France Schneider
Guide rail	Taiwan square guide rail
Cooling system	Constant temperature controller water chiller
Oiling system	Automatic oiling system
Electrical requirement	3 Phases 380V±10% 50HZ/60HZ or 3 Phases or single Phase 220V±10% optional

Equipment model	MT-L1530F / MT-L2040F / MT-L2560F
Laser type	Fiber laser
Rated output power	500W-12000W optional
Effective cutting range	1500*3000mm / 2000*4000mm / 2500*6000mm optional
Reposition accuracy	0.02mm
Laser wavelength	1080±5nm
Laser source	Raycus
Laser cutting head	Raytools
Control system	Cypcut
Reducer	Japan Shimpo
Drive system	Japan YASKAWA servo driver and motors
Pneumatic elements	Japan SMC
Electrical parts	France Schneider
Guide rail	Taiwan square guide rail
Cooling system	Constant temperature controller water chiller
Oiling system	Automatic oiling system
Electrical requirement	3 Phases 380V±10% 50HZ/60HZ or 3 Phases or single Phase 220V±10% optional



# SHEET & TUBE FIBER LASER CUTTING MACHINE

MORN's sheet and tube fiber laser cutting machine, engineered for comprehensive metal fabrication, enables you to develop new market opportunities without the heavy investment and floor space requirement of two separate machines.

Your productivity for either tube or sheet is not compromised compared to dedicated single purpose laser machines.

## Features

- One machine, dual use, cost-effective.
- Auto self-centering fixture system, quick and stable pipe/tube fixing.
- Dual temperature cooling and lubricating system ensuring durability and longevity.
- Top brand parts ensure high cutting precision and powerful cutting ability.

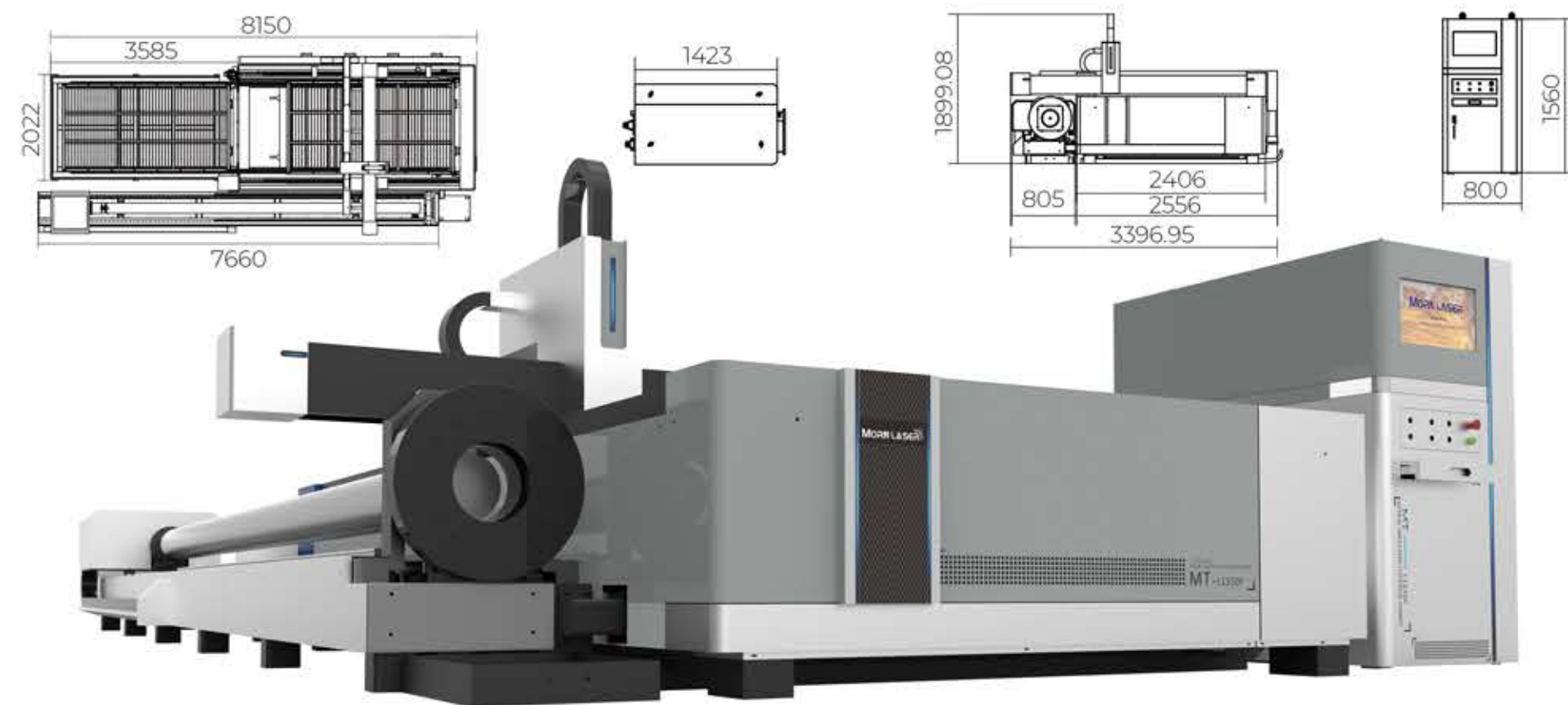

CS  $\phi$  160mm-320mm



Brass 1-40mm



CS 1-45mm



CS  $\phi$  160mm-320mm

Equipment model

Fiber laser source

Effective cutting range

Rotary diameter

Max. metal tube length

Laser wavelength

Laser source

Laser cutting head

Control system

Reducer

Drive system

Pneumatic elements

Electrical parts

Guide rail

Cooling system

Oiling system

Electrical requirement

MT-L1530FR / MT-L2040FR / MT-L2560FR

500W-12000W optional

1500\*3000mm / 2000\*4000mm / 2500\*6000mm optional

160mm / 220mm / 320mm optional

6m

1080 $\pm$ 5nm

Raycus / IPG / Max Photonics optional

Raytools

Cypcut

Japan Shimpo

Japan YASKAWA servo driver and motors

Japan SMC

France Schneider

Taiwan square guide rail

Constant temperature controller water chiller

Automatic oiling system

3 Phases 380V $\pm$ 10% 50HZ/60HZ or 3 Phases or single Phase 220V $\pm$ 10% optional



# TUBE FIBER LASER CUTTING MACHINE

MORN's tube fiber laser cutting machine is a professional tube profile laser cutter and supports cutting of round tube, square tube, rectangular tube, elliptical tube, waist tube, D-shaped tube, hexagonal tube, shaped tube, etc.

Equipped with self-centering jig system, the productivity is highly improved. Tube cutting lengths can be customized.

## Features

- Dedicated operating system, simple operation, low operating cost.
- Auto chucking chucks, high fixing efficiency, superior performance.
- Extremely robust, minimum size, maximum production rate.

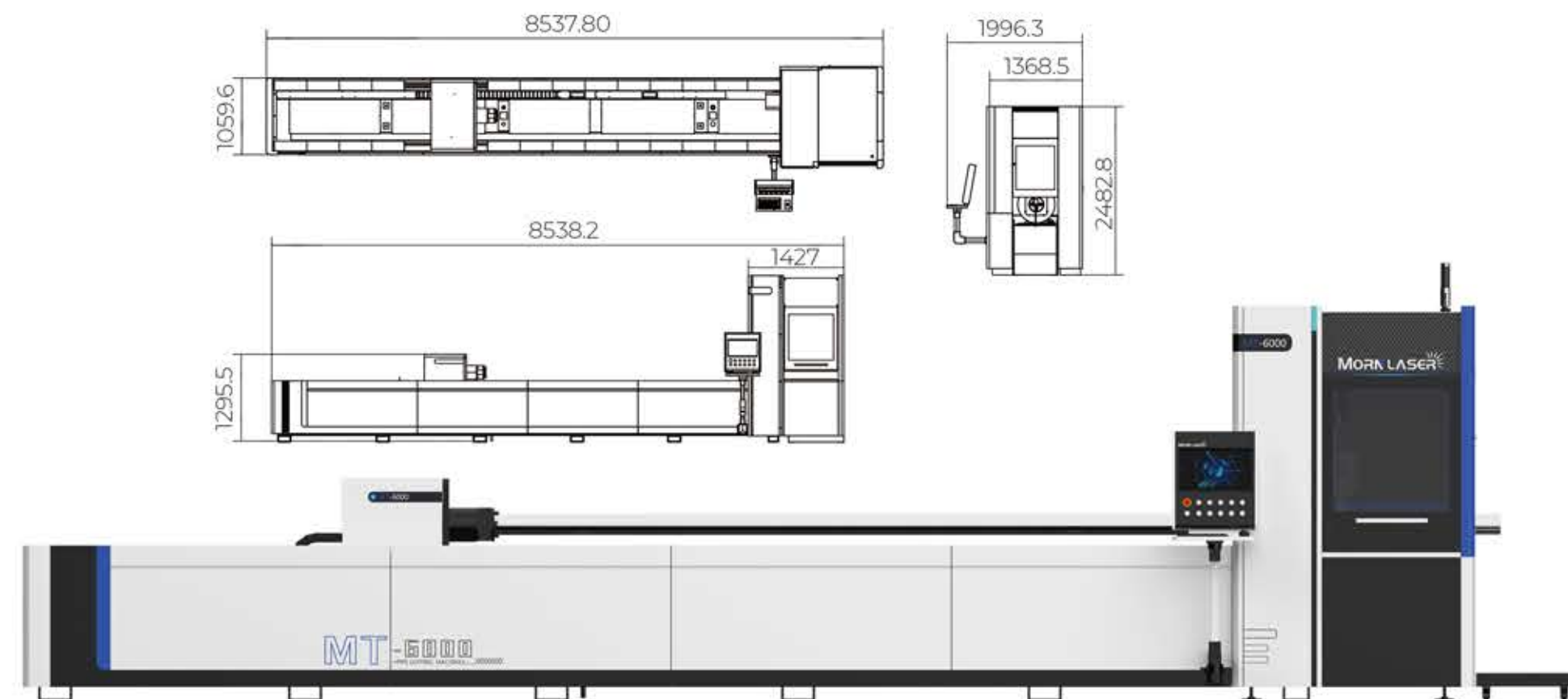

SS  $\phi$  160mm-320mm



GS  $\phi$  160mm-320mm



CS  $\phi$  160mm-320mm



Brass  $\phi$  160mm-320mm

Equipment model	MT-6000
Laser type	Fiber laser generator
Laser wavelength	1080 $\pm$ 5nm
Rated output power	500W-12000W
Effective pipe cutting length	6000mm
Effective pipe cutting diameter	20mm - 165mm/220mm/320mm optional
Workbench repositioning accuracy	$\leq \pm 0.02$ mm
Cutting speed	Depend on material and thickness
Cutting head	Switzerland Raytools laser head
Pneumatic elements	Japan SMC
Drive system	Japan Yaskawa servo motor and driver
Reducer	Japan Shimpo
Electrical parts	France Schneider
Water chiller	Industrial water chiller
Oiling system	Automatic oiling system
Control system	Cyptube / Tubepro
Electrical requirements	3 Phases 380V $\pm$ 10% 50HZ/60HZ or 3 Phases or single Phase 220V $\pm$ 10% optional



# ECONOMICAL SHEET FIBER LASER CUTTING MACHINE

MORN's economical fiber laser comes standard with a Raycus 1000W laser source for mid-thickness plate cutting.

It is the first choice for processing of metal words, advertising signs, billboards, decoration, panels, crafts, electrical cabinet, kitchen appliances, elevators, etc.

## Features

- Integrated design, small footprint, low cost.
- Fast and accurate processing of complex graphics.
- Non-contact processing, fine cutting edge, no need for post-processing.
- Wireless remote control, easy operation, free maintenance.

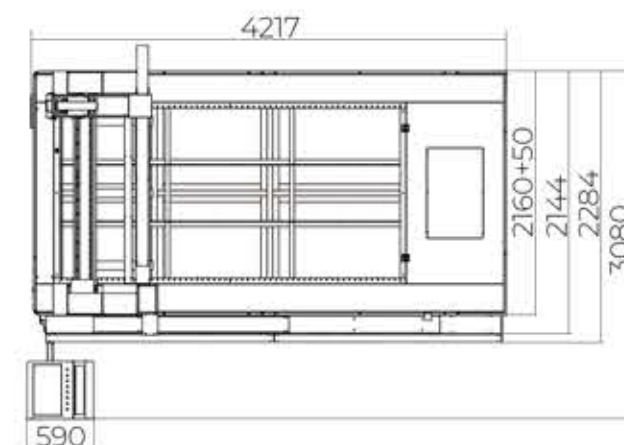
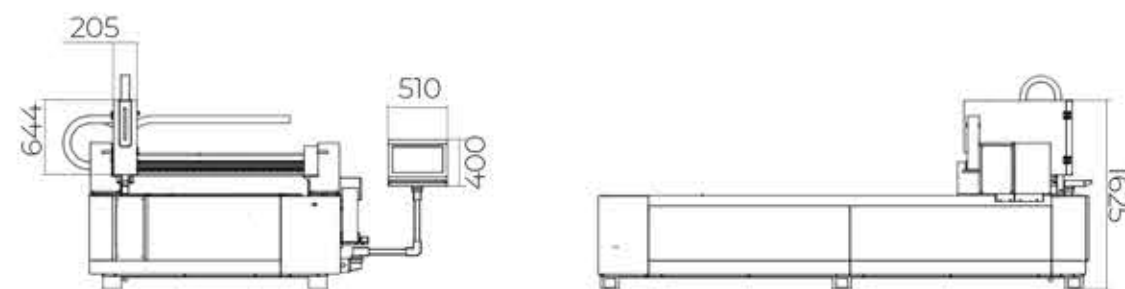

Brass 1-3mm



SS 1-5mm



CS 1-10mm



GS 1-5mm

Equipment model	MT-LF1530E
Laser type	Fiber laser
Rated output power	1000W
Effective cutting range	1500*3000mm (59" * 118")
Reposition accuracy	±0.05mm
Laser wavelength	1080±5nm
Laser source	Raycus
Laser cutting head	Raytools
Control system	Cypcut
Reducer	Japan Shimpo
Water chiller	Industrial water chiller
Electrical parts	France Schneider
Oiling system	Automatic oiling system
Electrical requirement	3 Phases 380V±10% 50HZ/60HZ or 3 Phases or single Phase 220V±10% optional



# MINI FIBER LASER CUTTING MACHINE

MORN's mini fiber laser cutter is known for its compact design, mature technology and high cutting precision, which is preferred by small workshops and DIY enthusiasts. It is popular for small and exquisitely detailed metal cutting such as decorative jewelry manufacture, advertising and general craft industries, etc.

## Features

- Centralized operation, fast and precise cutting.
- Compact and enclosed design, small footprint, easy to move.
- High precision, simple operation, maintenance-free.
- Low cost, fast returns.

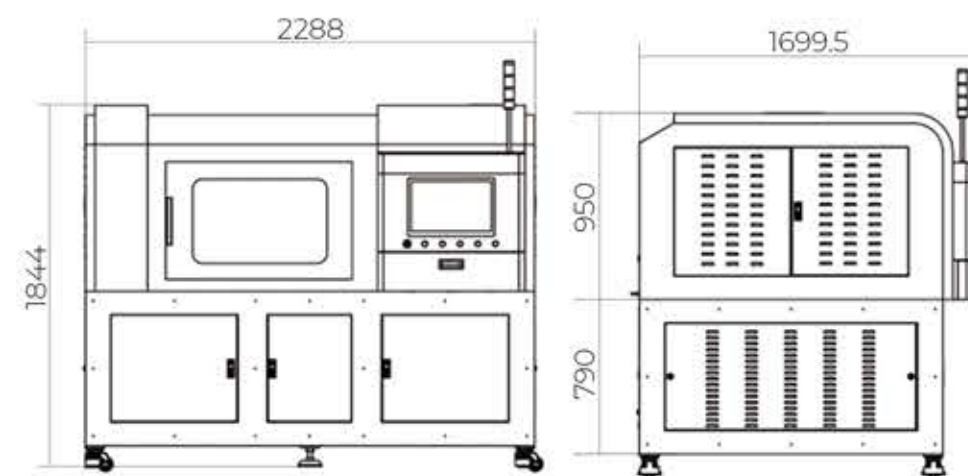

CS1-45mm



Aluminum 1-40mm



CS1-45mm



SS1-50mm

Equipment model	MT-L6090F
Laser type	Fiber laser generator
Laser wavelength	1080±5nm
Rated output power	500W-1500W
Effective cutting range	900*600mm
Workbench axial positioning accuracy	≤±0.1mm
Workbench repositioning accuracy	≤±0.02mm
Cutting speed	Depend on material and thickness
Max no-load speed	60m/min
Cutting head	Switzerland Raytools laser head
Pneumatic elements	Japan SMC
Drive system	Japan Yaskawa servo motor and driver
Reducer	Japan Shimpo
Water chiller	Industrial water chiller
Oiling system	Automatic oiling system
Software	Cypcut control software
Electrical requirements	3 Phases 380V±10% 50HZ/60HZ or 3 Phases or single Phase 220V±10% optional



# HANDHELD LASER WELDING MACHINE

## Advantages

1. Latest generation of fiber laser, self-developed wobble/common welding gun with safety sensing function and adjustable weld seam width;
2. Easy welding of large objects over long distances, and hard-to-reach places;
3. High strength and fine weld seam, no need for polishing, no consumables, no deformation;
4. 3-10 times the speed of conventional argon arc welding plasma welding;
5. Power consumption is 10-20% less than traditional process, save 2-3 labor costs;
6. Simple operation, long service life.

## Applications

Applicable for welding both same type materials and dissimilar materials. Widely used for welding of metal words, kitchen cabinets, steel structures, stairs, shelves, ovens, stainless steel door and window guardrails, elevators, distribution boxes, stainless steel houses etc.

## Materials

Titanium, aluminum, copper, zinc, gold, silver, carbon steel and stainless steel, and also cooperbrass, cooper-titanium, nickel-cooper, cooper-titanium and many other dissimilar metals.



Equipment model	MT-W500P / MT-W1000P / MT-W1500P / MT-W2000P
Laser source	Raycus
Laser power	500W/1000W/1500W/2000W
Output power tunability (%)	10-100%
Laser head	Handheld
Laser wavelength	1080±5nm
Fiber diameter	100 μm
Frequency of pulse	50~20khz
Fiber laser optic length	8m
Spot size	Φ0.2-1.8mm
Welding depth	0.8-1mm
Water chiller	S&A 500w / 1000w / 1500w / 2000w
Total power	5KW / 6KW / 8KW / 10KW
Ambient temperature	10℃~40℃
Relative humidity	≤70%
Power supply	AC 220V,50 / 60Hz,Single Phase AC 380V,50 / 60Hz,Three Phase
NW	220kg

Max welding thickness				
Power	Stainless steel	Carbon steel/Galvanized sheet	Aluminum	Brass
500W	3mm	2mm	0.5mm	0.5mm
1000W	4mm	3mm	1mm	1mm
1500W	4.5mm	3.5mm	1.5mm	1.2mm
2000W	5mm	4mm	2mm	2mm



# AUTOMATIC LASER WELDING MACHINE

## Advantages

1. Accurate and fast welding of complex parts, logo, metal words, etc.
2. Solid and perfect welds fully meet the welding requirements of different industries;
3. CCD camera monitoring system, real-time display of welding effect;
4. 360° rotation welding, large welding range, flexible welding of hard-reach position;
5. Can be upgraded with a handheld welding gun to achieve manual welding;
6. High electro-optic conversion rate, low energy consumption;
7. Suitable for 24h industrial mass production.



## Applications

- Auto parts: hydraulic ejector, filter, sensor, solenoid valve, etc.
- Lithium-ion battery: extreme materials, cylindrical caps, etc.
- Mobile phone industry: mobile phone backplane, studs, card slots, etc.
- Electronic industry: sensors, motor rotors, capacitors, relays, etc.
- Kitchen and bathroom appliances: kettle, faucet, hook, sink, range hood, etc.

## Material:

Titanium, aluminum, copper, zinc, gold, silver, carbon steel and stainless steel, and also cooper-brass, cooper-titanium, nickelcooper, cooper-titanium and many other dissimilar metals.



Model	MT-W1000 / MT-W1500 / MT-W2000
Laser source	1000W/1500W/2000W
Laser head	Automatic
Welding depth	0.8-1mm
Output power tunability	10-100%
Emission wavelength	1080±5nm
Modulation Frequency	50-20kHz
Spot size	Φ0.2-1.8mm
Power supply	AC 220V 50Hz single phrase / AC 380V 50Hz three phrase
Electric current	10-32A
Total power	6kw / 8kw / 10kw
Operating tempereature	10-40℃<70% Humidity
Cooling method	Water cooling S&A 1000w / 1500w / 2000w
Rotary	For option
Material	SS, CS, Brass, Aluminum, Galvanized sheet
Weight	400kg
Package Dimension:	161*127*145cm



# HANDHELD YAG LASER WELDING MACHINE

## Advantages

- 1.Integrated energy negative feedback laser energy control technology can achieve consistency of welding results from start to finish;
- 2.High power density, extremely fast melting process, low heat input, small heat affected zone;
- 3.Suitable for spot welding, butt welding, overlap welding, sealing welding of thin-walled materials and precision parts;
- 4.Aesthetically pleasing weld seam with strength comparable to substrate material, no need for polishing, no consumables, no deformation.



## Applications

- Auto parts: engine cylinder gasket, hydraulic tappet seal welding.
- Filter seal welding, the sport plug welding, valve push rod welding.
- Anti-collision airbag electric detonator seal welding, crankshaft or cylinder liner or heat treatment, etc.
- Stainless steel advertising words, microelectronics components, precision parts, high digital components, optical fiber connector, medical apparatus and instruments, etc.

## Materials

Titanium, aluminum, copper, zinc, gold, silver, carbon steel and stainless steel, and also cooper-brass, cooper-titanium, nick-elcooper, cooper-titanium and many other dissimilar metals.



Laser model	YAG
Model	MT-WY200P / MT-WY400P
Welding held	handheld
NW	300kg
Wavelength	1064nm
Machine dimension	159*79*137cm
Fiber laser optic length	5m
Laser power	200W/400W
Pulse frequency	1-100
Pulse width	0.1-20ms
Max signal pulse energy	90J
Max signal pulse	0.1-0.5mm
Viewing system	CCD
Power	380v±10% 50Hz / 60Hz
Rated power	≤6kw
Cooling	Water cooling
Working area	300*200 (500*300, 700*500 for option)



# LASER CLEANING MACHINE

## Advantages

- 1.No need chemical cleaning solution, no consumables, safe and environmental protection;
- 2.Non-contact cleaning, no damage to parent material;
- 3.Precise position and specific size cleaning, efficient and good surface cleanliness;
- 4.Suitable for long-distance and large object cleaning;
- 5.Easy removal of almost all kinds of impurities, including oxides, greases, rust, paints, chlorides and many other organic and inorganic residues.

## Applications

Applicable for cleaning of mold, aircraft old paint, weapons and equipment, tough oil paint, grease, mineral oil, building exterior, ancient currency, cultural relics, etc..



<b>Model</b>	MT-CL100/MT-CL200/MT-CL300/MT-CL500/MT-CL1000
<b>Power</b>	100W/200W/300W/500W/1000W
<b>Optional</b>	100W-1000W
<b>Power consumption</b>	800W-6000W
<b>Working environment</b>	Flat, no vibration, no impact
<b>Size</b>	1180mm×750mm×1280mm
<b>weight</b>	200Kg
<b>Fiber length</b>	5m
<b>Cleaning head weight</b>	2.5Kg
<b>Moving way</b>	Hand pushing
<b>Scanning width</b>	10-80mm
<b>Power adjustment range (%)</b>	10-100(Adjustable gradient)
<b>Center wavelength (nm)</b>	1064
<b>Cooling model</b>	Air-cooled(100W); Water-cooled(≥200W)
<b>Electrical requirement</b>	220V±10% 50Hz/60Hz

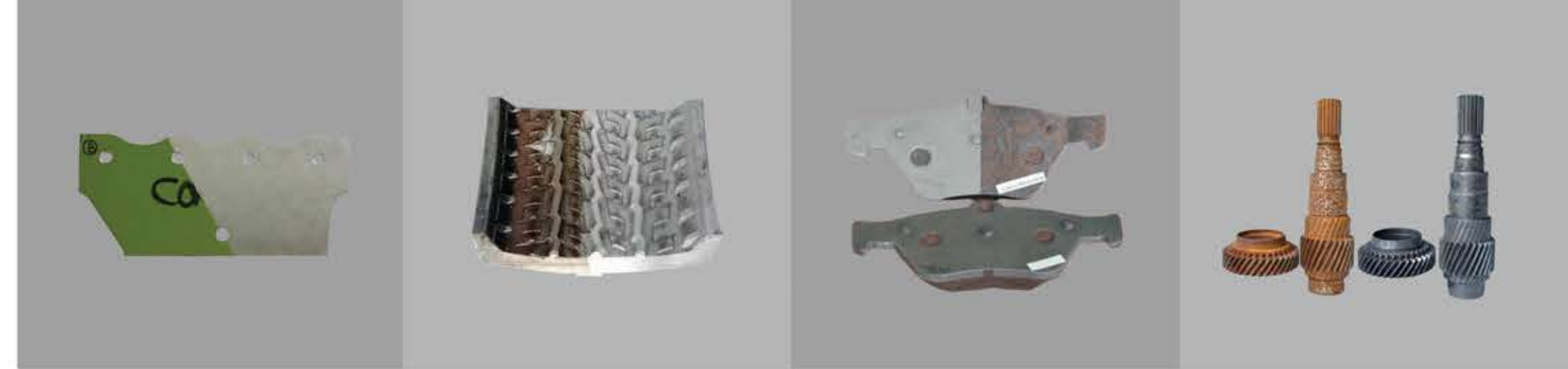

Comparison	Chemical cleaning	Mechanical polishing	Ultrasonic cleaning	Laser cleaning
Workpiece damage	Yes	Yes	No	No
Cleaning effect	Uneven	Uneven	Excellent, small cleaning range	Very good, high cleanliness
Cleaning accuracy	Uncontrollable, poor	Uncontrollable, normal precision	Unspecified range cleaning	High
Environmental pollution	Serious	Yes	No	No
Operation	Protective measures required	Safety protection required	Manual replacing of consumables	Handheld or integrated automation
Consumables	Chemical cleaning agent	Sandpaper, grinding wheel, oil stone, etc.	Special cleaning solution	Only power



# DESKTOP FIBER LASER MARKING MACHINE

Desktop fiber laser marking machine, equipped with a large area working table, is the bestselling laser marker. Owing to the four casters, you can smoothly change the positions of your marking jobs.

## Applications

Jewelry, animal rings, electric parts, hardware, machinery agricultural implements, sports equipment, shower accessory, advertising, construction works, energy & mining, etc.

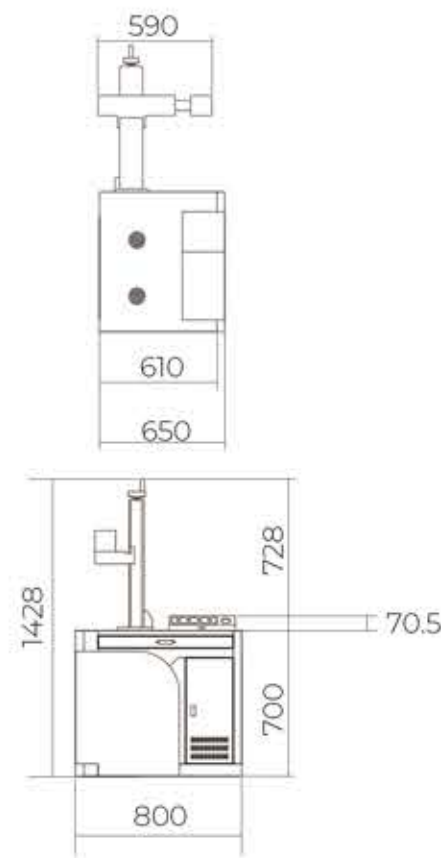

## Features

1. Movable: With 4 caster wheels, suitable for mobile working environments;
2. Large space: The space on desk provides platform for different size material marking.
3. Standout performance: High marking quality with high speed(up to 7000mm/s); 2-3 times higher than traditional marking;
4. Long Lifetime: advanced laser generator, lifespan is 100,000h;
5. Easy operation: Marking software preinstalled and machine parameters pre-set, plug and play.



Note: color marking  
needs MOPA laser source



Model	MT-F20A / MT-F30A / MT-F50A / MT-F70A / MT-F100A
Laser power	20W-100W
Marking area	110*110mm/200*200mm/300*300mm
Cooling mode	Air Cooling
Laser wavelength	1064nm
Pulse frequency	20-100Khz
Marking speed	0-7000mm/s
Minimum line width	0.01mm
Minimum character	0.15mm
Marking content	Text, pattern, date, bar code, etc
Operation system	Windows xp/ 7 / 8 / 10
Control software	EZCAD Control Software
Graphic format supported	JPG, AI,DXF, PLT, PNG,etc.
Unit power	≤0.8 KW
Operation temperature	5°C-40°C
Power supply	110V/220V±10%, 50Hz/60Hz
Optional	Rotary device/2D work table



# MINI FIBER LASER MARKING MACHINE

Mini fiber laser marking machine is lightweight and compact. You can easily take it anywhere to start your marking. A rotating device can be added for easy marking of round objects.

## Features

- One-piece design: space-saving, lightweight, wide working applications.
- Portable type: easy to move and to change working places.
- Fixed head: suitable for batch marking of materials with same size and height.
- Standout performance: consistent marking quality with high speed(up to 7000mm/s), 2-3 times higher than traditional marking.

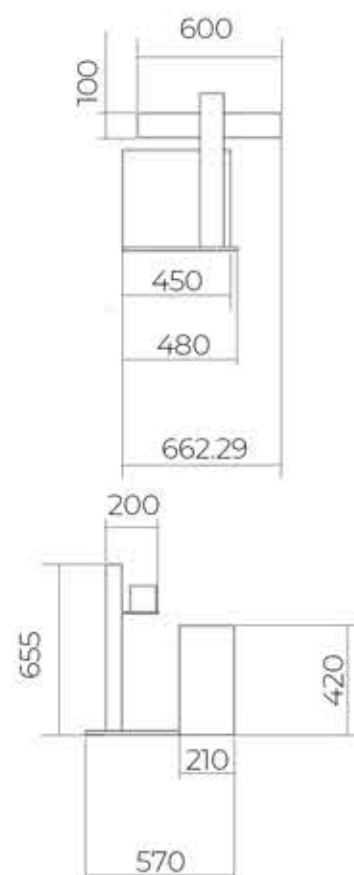

## Applications

Auto parts  
Electronic components  
Mechanical parts  
Instrumentation  
Hardware tools  
Daily necessities  
Etc.



Model	MT-FP20B / MT-FP30B / MT-FP50B / MT-FP70B / MT-FP100B
Laser power	20W-100W fiber laser source
Marking area	110*110mm-300*300mm
Cooling mode	Air Cooling
Laser wavelength	1064nm
Pulse frequency	20-100KHz
Marking speed	0-7000mm/s
Minimum line width	0.01mm
Minimum character	0.15mm
Marking content	Text, pattern, date, bar code, etc
Operation system	Windows xp/ 7 / 8 / 10, etc
Control software	EZCAD control software
Graphic format supported	JPG, AI,DXF, PLT, PNG,etc.
Unit power	≤0.8 KW
Operation temperature	5°C-40°C
Power supply	110V/220V±10%, 50Hz/60Hz
Optional	Rotary device/2D work table



# ALL SEALED FIBER LASER MARKING MACHINE

All sealed fiber laser marking machine offers accurate, safe and clean marking. With a closed safety protection system, it can avoid accidental injury caused by incorrect operation as well as exposure to laser radiation, dust and smoke.

- Enclosed cabinet: Prevent eye damage caused by long working time.
- Laser head: Fully covered, avoid being exposed to outside dirt and dust.
- Safe operation: Reduce the damage caused by the generated smoke .
- Electric lift: Saves time of moving manually.
- Europe standard: The enclosure meets Europe standard of safety regulations.

## Applications

Electronics, clocks, cutlery, precision equipment, mobile phone case, auto parts, medical instruments, etc.



Note: color marking  
needs MOPA laser source



Model	MT-F20C / MT-F30C / MT-F50C / MT-F70C / MT-F100C
Laser power	20W-100W
Marking area	110*110mm-200*200mm
Cooling mode	Air Cooling
Laser wavelength	1064nm
Pulse frequency	20-100Khz
Marking speed	0-7000mm/s
Minimum line width	0.01mm
Minimum character	0.15mm
Marking content	Text, pattern, date, bar code, etc
Operation system	Windows xp/ 7 / 8 / 10
Control software	EZCAD control software
Graphic format supported	JPG, AI,DXF, PLT, PNG,etc.
Unit power	≤0.8KW
Operation temperature	5°C-40°C
Power supply	110V/220V±10%, 50Hz/60Hz
Optional	Rotary device/2D work table



# PORTABLE FIBER LASER MARKING MACHINE

Portable fiber laser marking machine has an overall size as small as a desktop computer. It comes standard with a 2D table for easy adjusting of marking focus. The whole modular design makes it compact, light, and easy to carry in car or be transported by express courier. You could enjoy your marking time freely at the office, home, workshop, yards, craft shop, etc.

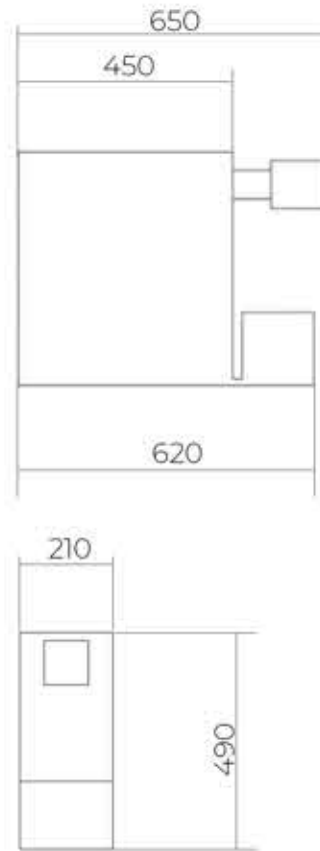

## Features

1. One-piece design: space-saving, lightweight, wide working applications;
2. Portable type: easy to move and to change working places;
3. Fixed head: suitable for batch marking of materials with same size and height;
4. Standout performance: consistent marking quality with high speed (up to 7000mm/s), 2-3 times higher than traditional marking.

## Applications

1. Auto Parts: car body, frame, chassis, girders, piston rings, shafts, bushes, clutches, lights, engines, connecting rods, cylinders, pistons, cylinder liners, gears, pumps, spring steel plates, etc.
2. Electronic Components: resistors, capacitors, chips, printed circuit boards, keyboards, etc.
3. Mechanical parts: machine tools, hardware, steel pipes, casings, couplings, cones, pumps, body valves, flanges, fasteners; bearings, gears, standard parts, motor, etc.
4. Instrumentation: panels, signs, precision instruments, etc.
5. Hardware tools: measuring tools, locks, cutting tools, etc.
6. Daily necessities: crafts, zippers, key chains, jewelry rings, sanitary ware, etc.



Model	MT-FP20A / MT-FP30A / MT-FP50A
Laser power	20W-50W
Marking area	110*110mm
Cooling mode	Air Cooling
Laser wavelength	1064nm
Pulse frequency	20-100Khz
Marking speed	0-7000mm/s
Minimum line width	0.01mm
Minimum character	0.15mm
Marking content	Text, pattern, date, bar code, etc
Operation system	Windows xp/ 7 / 8 / 10
Control software	EZCAD Control software
Graphic format supported	JPG, AI, DXF, PLT, PNG, etc.
Unit power	≤0.8 KW
Operation temperature	5°C-40°C
Power supply	110V/220V±10%, 50Hz/60Hz
Power Stability	<±1%RPM



# HANDHELD FIBER LASER MARKING MACHINE

Handheld Fiber Laser Marking Machine replaces the previous fixed light path with a hand-held head for easy marking of large workpieces and long-distance applications. It comes standard with a 2D worktable for micro adjustment of workpieces during marking process.

## Features

- Handheld type: suitable for marking large heavy objects.
- Highly integrated: suitable for wide range of applications.
- Modular design: compact, easy to move or repair.
- Simple operation: easy to mark.



## Applications

Hardware tools  
Kitchen utensils  
Plastic products  
Computer keyboards  
Metal accessories  
Buttons  
Integrated circuits  
Packaging bottles  
Glasses frames  
Sanitary faucets  
Etc.



Model	MT-FP20C / MT-FP30C / MT-FP50C
Laser power	20W-50W
Marking area	110*110mm
Cooling mode	Air cooling
Laser wavelength	1064nm
Frequency of pulse	20-100Khz
Marking speed	0-7000mm/s
Minimum line width	0.01mm
Minimum character	0.15mm
Marking content	Text, pattern, date, bar code, etc
Operation system	Windows xp/ 7 / 8 / 10
Control software	EZCAD Control Software
Graphic format supported	JPG, AI, DXF, PLT, PNG, etc.
Unit power	≤0.8 KW
Operation temperature	5°C-40°C
Power supply	110V/220V±10%, 50Hz/60Hz
Power Stability	<±1%RPM



## CUSTOMIZED TYPES

MORN's customized marking machines include big size marking machine, desktop handheld fiber laser cutting machine, bulb marking machine and super mini fiber laser marking machine. Flying marking, camera position marking and assembly line marking types can also be customized to satisfy varied marking requirements.



**Bulb marking machine**  
Large scale bulbs marking:  
aluminum rotary platform,  
8 stations.

**Super mini fiber laser  
marking machine**  
All in one design: Laser source,  
marking software, 8mm high  
speed scanner, power supply,  
Intel IPC.

**Desktop handheld Fiber  
Laser Marking Machine**  
Two-in-one design: It can  
achieve both standard  
desktop marking and  
movable marking.

**Big size marking machine**  
Provide big marking area:  
600x600mm/1000x1000mm  
Application:  
Perfect for large size objects  
marking.

### Co2 Laser Marking Machine

1. Applicable materials: wood, acrylic, MDF, color board, plastic, carton, paper, leather, fruit (watermelon), etc.
2. Advantage: comparing to CO2 laser engraving machine, CO2 laser marking machine has faster marking speed: 7000mm/s, can save the customers time cost for quantity product marking.
3. Marking head: imported high-speed galvanometer, ammeter type, high accuracy.
4. Industrial computer: ensuring long-term stable work in the harsh industrial environment.
5. Stable performance: stable light output, low failure rate, long-term continuous work, high lifespan, low maintenance cost.
6. High tech: can be integrated into an assembly line with conveyor belt.

### Fiber Laser Assembly Line Marking Machine

1. Automatic marking process, fast speed, high efficiency.
2. High electro-optical conversion efficiency, small size, low operating cost, no consumables and maintenance-free.
3. The overall performance of the device is stable, the light output system can be adjusted back and forth, up and down, and it has a red-light focus indicating device.
4. Easy operation, wide applications, suitable for marking of multiple materials.
5. Directly matching the assembly line, it reduces production conversion links and labor cost; owing to 24-hour continuous working ability, it can meet the requirements of industrialized large-scale production.
6. The control software adopts WINDOWS interface, which supports automatic coding, variable text, serial number, batch number, date, various barcodes and two-dimensional code marking, and can be flexibly modified according to the different needs of customers' production lines.





# BIG SIZE CO2 LASER CUTTING MACHINE

Big size CO2 laser cutting machine is designed specifically for processing large format materials with superior speed and precision.

Features including the high-cutting speeds, four-sided access mean that you can achieve maximum productivity at all times.

The perfectly matched and high-quality components ensure a very long lifetime. All models of CO2 laser cutters are pre-installed with Rdworx graphic design software supporting commonly used graphic formats.

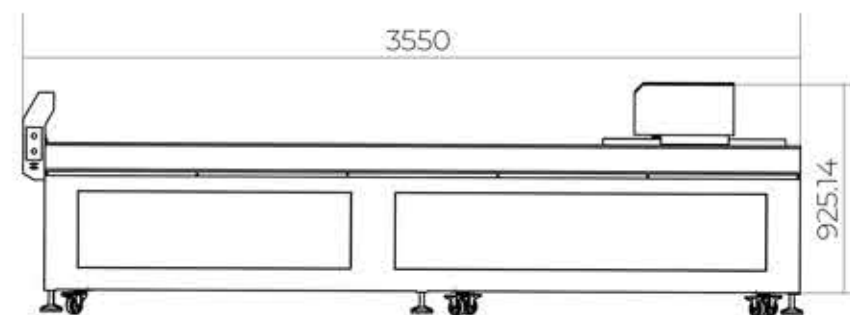
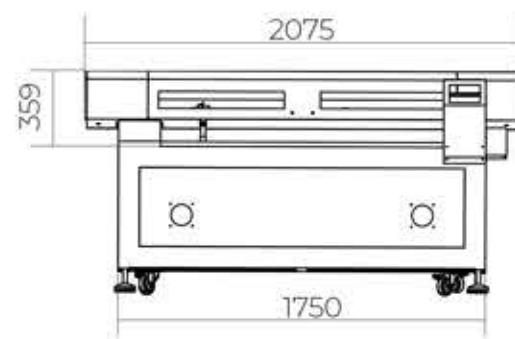

Model	MT-L1325
Max working area	1300*2500mm
Laser tube watts	80W-150W
Table	Knife strip/ Honey comb worktable
Laser tube type	Hermetic CO2 glass tube
Motion drive system	High-speed stepper motors
Control software	RD Works
Resolution rate	≤4500dpi
Locating precision	0.01mm
Repetition accuracy	0.02mm
Minimum character	1*1mm
Intelligent memory	Store files up to 128MB
Compatible software	Coreldraw, Autocad, Photoshop
Graphic format	BMP, PLT, DST, AL, DXF
Electrical requirements	AC 110-220V ±10%
Print interface	Ethernet or USB interface.Compatible with windows8/7/XP,etc



# CO2 LASER ENGRAVING AND CUTTING MACHINE

MORN CO2 Engraving and Cutting Machine offers precise and aesthetical engraving and cutting of non-metal materials, such as acrylic, leather, paper, MDF, rubber, wood board, glass, and other non-metallic materials.

- Cover Open Protection: automatically cut off the power when the cover is open, protect the human beings from radiation or hurt by the laser;
- Red-dot Positioning: use red light indication method to achieve precise positioning of the laser beam;
- Worktime Preview Function: real-time display and tracking of machining progress.

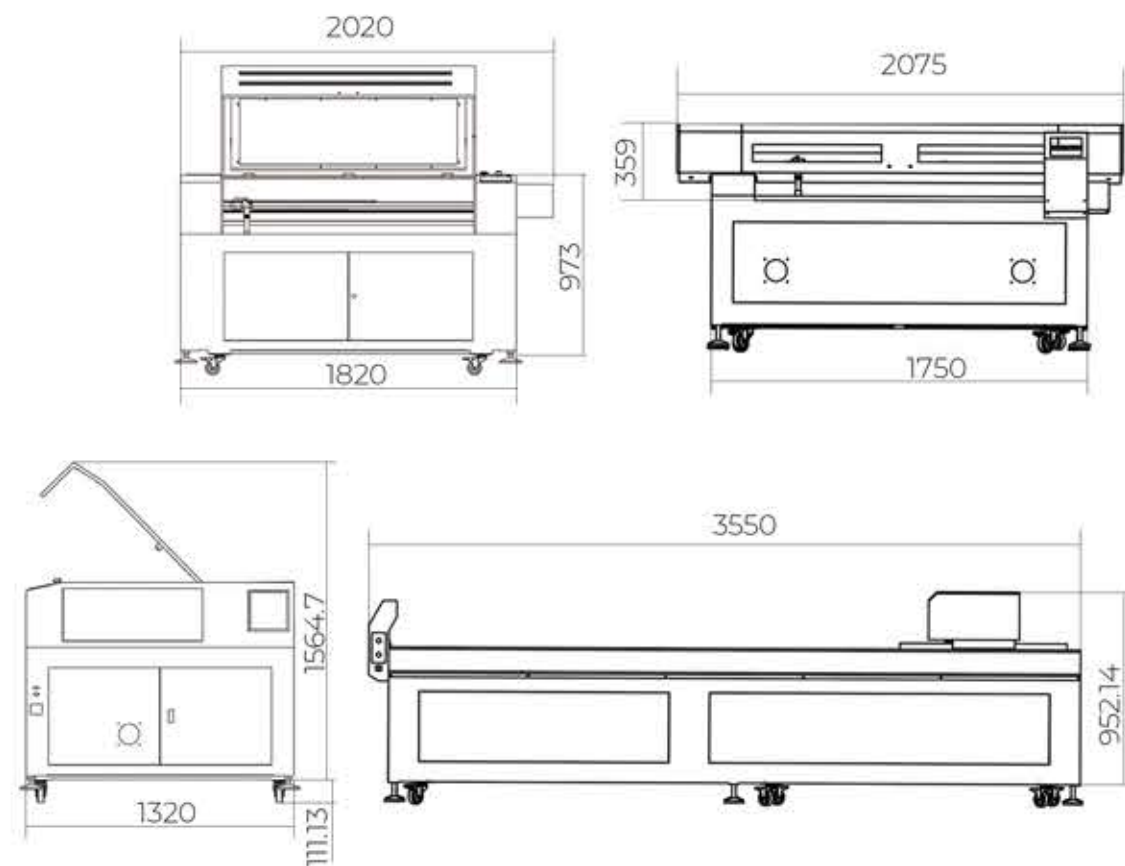

Model	MT-L960 / MT-L1390
Max working area	900*600mm / 1300*900mm
Laser tube watts	60W-100W/80W-150W
Table	Knife strip/ Honey comb worktable
Laser tube type	Hermetic CO2 glass tube
Motion drive system	High-speed stepper motors
Control system	Advanced DSP control system
Control software	RD Works
Resolution rate	≤4500dpi
Locating precision	0.01mm
Repetition accuracy	0.02mm
Minimum character	1*1mm
Intelligent memory	Store files up to 128MB
Compatible software	Coreldraw, Autocad, Photoshop
Graphic format	BMP, PLT, DST, AL, DXF
Electrical requirements	AC 110-220V ±10%
Print interface	Ethernet or USB interface.Compatible with windows8/7/XP,etc
Optional	8-axis/rotary



# DUAL HEAD CO2 LASER CUTTING MACHINE

Dual head CO2 laser cutting machine is designed for high speed cutting efficiency.

Two independent laser power supplies drive two independent laser tubes, put the moving control into full play.

The sturdy construction with high-end precision linear rails ensure smooth, fast motion.

Bottles and round objects engraving can be achieved with a rotary attachment (sold separately).

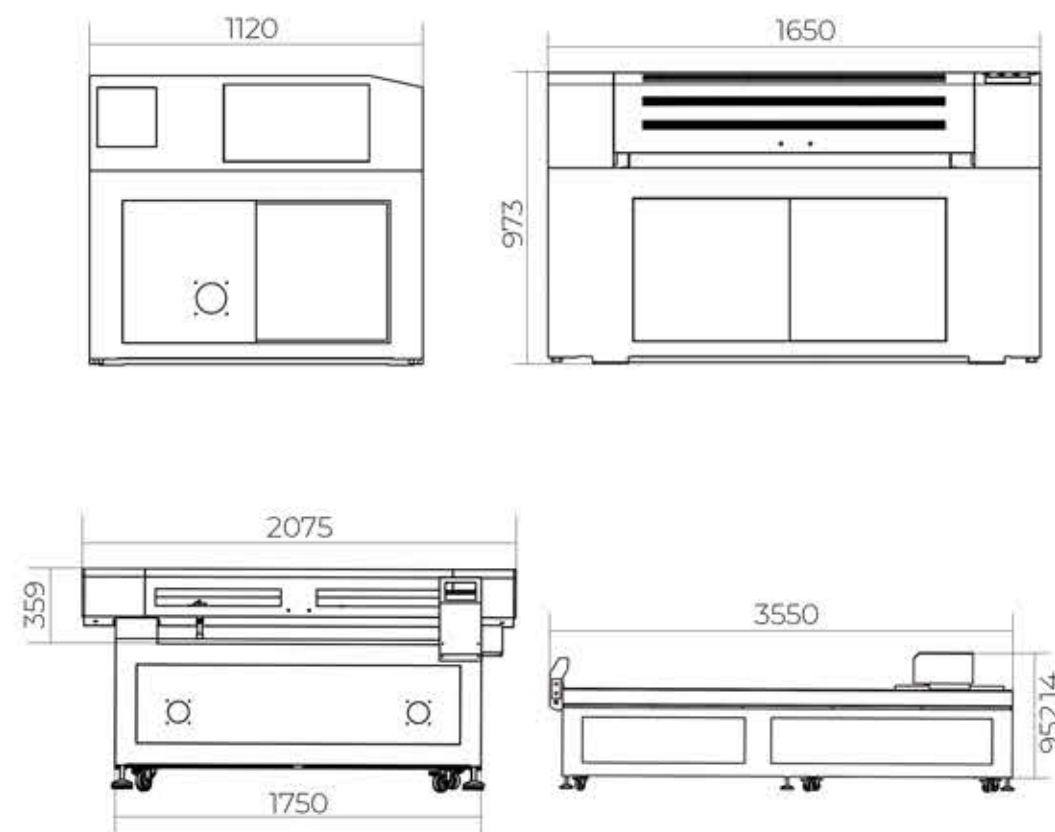

Model	MT-L960D / MT-L1390D / MT-L1325D
Max working area	900*600mm / 1300*900mm / 1300*900mm
Laser tube watts	60W-100W/80W-150W/80W-180W
Table	Knife strip/ Honey comb worktable
Laser tube type	Hermetic CO2 glass tube
Motion drive system	High-speed stepper motors
Control system	Advanced DSP control system
Control software	RD Works
Resolution rate	≤4500dpi
Locating precision	0.01mm
Repetition accuracy	0.02mm
Minimum character	1*1mm
Intelligent memory	Store files up to 128MB
Compatible software	Coreldraw, Autocad, Photoshop
Graphic format	BMP, PLT, DST, AL, DXF
Electrical requirements	AC 110-220V ±10%
Print interface	Ethernet or USB interface.Compatible with windows8/7/XP,etc
Optional	2 axiz/rotary



# FABRIC CO2 LASER CUTTING MACHINE

Fabric CO2 laser cutting machine has a motor-controlled automatic feeding system which ensures the flatness of the fabric during cutting and feeding.

It is able to cut a wide range of fabrics and textiles: nylon, polyester, polyester cotton, linen, felt, fleece, lycra, chiffon, mohair, wool, silk, cotton, denim, rayon & hemp, etc.

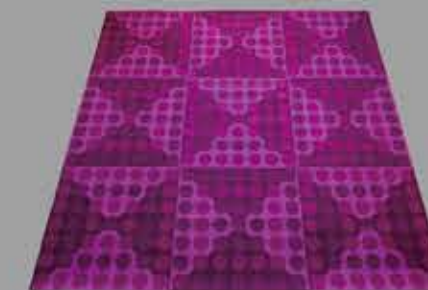
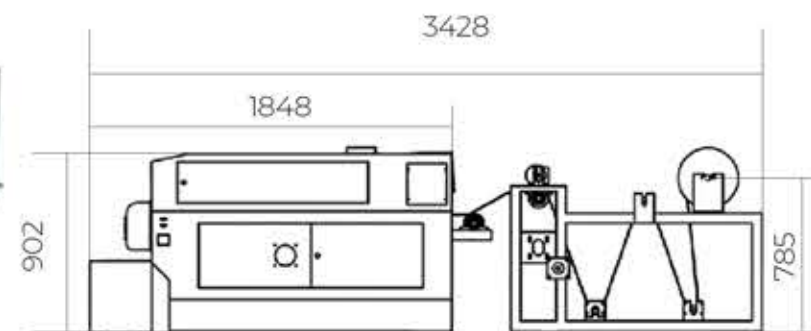
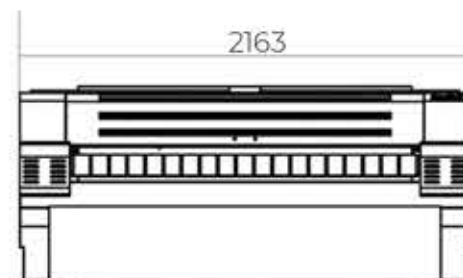

Model	MT-L1610A
Max working area	1600*1000mm
Laser tube watts	80W-180W
Table	Automatic feeding
Laser tube type	Hermetic CO2 glass tube
Motion drive system	High-speed stepper motors
Control system	Advanced DSP control system
Control software	RD Works
Resolution rate	≤4500dpi
Locating precision	0.01mm
Repetition accuracy	0.02mm
Minimum character	1*1mm
Intelligent memory	Store files up to 128MB
Compatible software	Coreldraw, Autocad, Photoshop
Graphic format	BMP, PLT, DST, AL, DXF
Electrical requirements	AC 110-220V ±10%
Print interface	Ethernet or USB interface.Compatible with windows8/7/XP,etc



## GLOBAL SERVICE

### 1. PRE-SALES SERVICE

- **Focus on Customers' Needs**

Conduct comprehensive analysis of customer needs such as metal/non-metal processing, work environment, packaging & transportation, etc.

- **Consultation and Market Analysis**

We provide technical consultation and feasible laser solutions as well as laser market analysis to assist you building business.

- **Customized Solutions**

Customized solutions are also available for diverse needs.

- **Sample Making**

We make samples on basis of customers' processing requirements to ensure processing quality and precision.

### 2. AFTER-SALES SERVICE

- **Installation Service**

We will supply the machine with Installation Manual and User Manual in English or other language (if required), as well as videos for installation, operation, maintenance and trouble-shooting of the machine.

Online technical guidance will also be offered via E-mail, Telephone, Skype, WhatsApp, Viber, Imo and Wechat, to further assist your installation. (Recommended)

- **Training Service**

Customers can send technicians to our factory for face to face training on installation, operation, commissioning and maintenance of the machine, where well-assembled machines, all sorts of tools and testing devices are in place. (Recommended)

- **On-site Service**

We can send technicians to customer's factory for machine installation and commissioning as well as operation training.

- **Lifelong Business Support**

Lifelong support will be provided to further assist customers. We may also pay irregular visits to customer's factory for routine maintenance, problem solving and technical guidance.

### 3. QUALITY GUARANTEE

We guarantee the quality of the machine are in conformity with relevant manufacturing standards and the terms of contracts and agreements. We provide free main parts during warranty period and fast supply of parts out of warranty period.

### 4. SERVICE COMMITMENT

We adhere to the service-oriented concept and offer "121" service:

1: respond to inquiries within 1 hour.

2: provide solutions within 2 days.

1: make samples within 1 day.



## EXHIBITION PICTURES

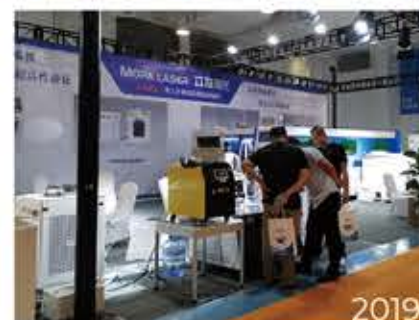
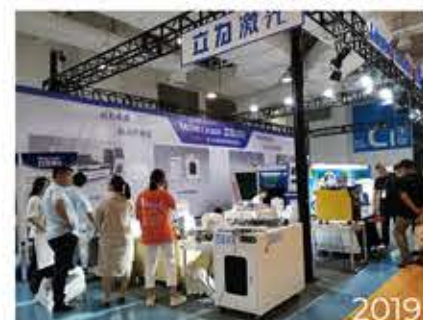

## ON-SITE INSTALLATION



## CLIENT FEEDBACK

